

TOLERANCES

- (A) Outside Diameter: (+/- 0.12)
- (B) Inside Diameter: (+/- 0.12)

THICKNESS

- (T) NPS: ≤ 18 - (HBS + 0.12, -0)
- (T) NPS: ≥ 20 - (HBS + 0.19, -0)
- (T) NPS: ≥ 26 - (HBS + 0.25, -0)

- (X) ID Groove (+/- 0.12)
- (Y) Width of Slot (+/- 0.12)
- (U) Depth of Slot (+/- 0.06)

STANDARD FINISHES

- Smooth Mill (Some Scale May Be Apparent)
- Spiral Serrated Machine (125-250 AARH)

All Units: Inches, Pounds

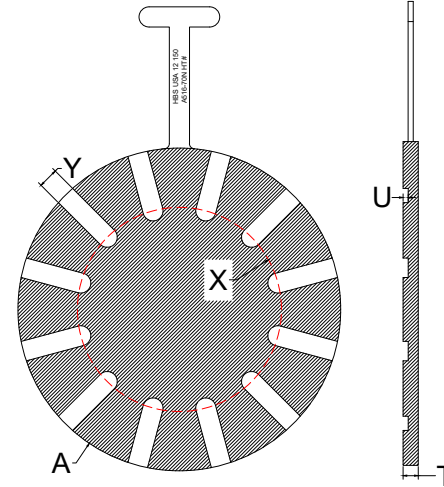

24 HOUR CALL OUT
409.736.7665

| 2500# | OD (A) | THICKNESS (T) | # GROOVES (Z) | ID GROOVE (X) | GROOVE WIDTH (Y) | DEPTH OF GROOVE (U) | WEIGHT |
|-------|--------|---------------|---------------|---------------|------------------|---------------------|--------|
| 1/2 | 2.62 | 0.88 | 4 | 0.25 | 0.25 | 0.25 | 4 |
| 3/4 | 2.88 | 0.88 | 4 | 0.43 | 0.25 | 0.25 | 4 |
| 1 | 3.25 | 0.88 | 4 | 0.60 | 0.28 | 0.25 | 5 |
| 1-1/4 | 4.00 | 0.88 | 4 | 0.90 | 0.38 | 0.25 | 6 |
| 1-1/2 | 4.50 | 0.88 | 4 | 1.10 | 0.38 | 0.25 | 6 |
| 2 | 5.62 | 0.62 | 4 | 1.50 | 0.50 | 0.25 | 6 |
| 2-1/2 | 6.50 | 0.62 | 4 | 1.77 | 0.75 | 0.25 | 9 |
| 3 | 7.62 | 0.62 | 4 | 2.30 | 0.75 | 0.25 | 11 |
| 4 | 9.12 | 0.62 | 8 | 3.15 | 0.75 | 0.25 | 15 |
| 5 | 10.88 | 0.62 | 8 | 4.06 | 1.00 | 0.25 | 20 |
| 6 | 12.38 | 0.62 | 8 | 4.90 | 1.00 | 0.25 | 24 |
| 8 | 15.12 | 0.62 | 8 | 6.87 | 1.00 | 0.25 | 35 |
| 10 | 18.62 | 0.62 | 12 | 8.50 | 1.00 | 0.25 | 51 |
| 12 | 21.50 | 0.62 | 12 | 10.12 | 1.00 | 0.25 | 67 |