

### TOLERANCES

- (A) Outside Diameter: (+/- 0.12)
- (B) Inside Diameter: (+/- 0.12)

### THICKNESS

- (T) NPS:  $\leq 18$  - (HBS + 0.12, -0)
- (T) NPS:  $\geq 20$  - (HBS + 0.19, -0)
- (T) NPS:  $\geq 26$  - (HBS + 0.25, -0)

- (X) ID Groove (+/- 0.12)
- (Y) Width of Slot (+/- 0.12)
- (U) Depth of Slot (+/- 0.06)

### STANDARD FINISHES

- Smooth Mill (Some Scale May Be Apparent)
- Spiral Serrated Machine (125-250 AARH)

All Units: Inches, Pounds

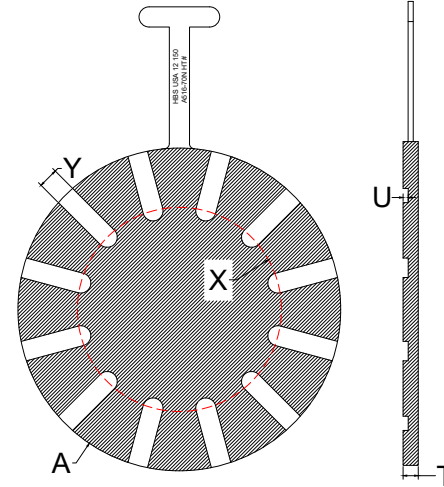

**24 HOUR CALL OUT**  
409.736.7665

300#	OD (A)	THICKNESS (T)	# GROOVES (Z)	ID GROOVE (X)	GROOVE WIDTH (Y)	DEPTH OF GROOVE (U)	WEIGHT
1/2	2.00	0.88	4	0.25	0.25	0.25	3
3/4	2.50	0.88	4	0.43	0.25	0.25	4
1	2.75	0.88	4	0.60	0.25	0.25	4
1-1/4	3.12	0.88	4	0.90	0.38	0.25	4
1-1/2	3.62	0.88	4	1.10	0.38	0.25	5
2	4.25	0.62	4	1.50	0.50	0.25	4
2-1/2	5.00	0.62	4	1.77	0.75	0.25	5
3	5.75	0.62	4	2.30	0.75	0.25	6
3-1/2	6.38	0.62	8	2.72	0.75	0.25	7
4	7.00	0.62	8	3.15	0.75	0.25	9
5	8.38	0.62	8	4.06	1.00	0.25	11
6	9.75	0.62	8	4.90	1.00	0.25	15
8	12.00	0.62	8	6.87	1.00	0.25	23
10	14.12	0.62	12	8.50	1.00	0.25	31
12	16.50	0.62	12	10.12	1.00	0.25	41
14	19.00	0.62	12	11.18	1.00	0.25	53
16	21.12	0.62	16	12.81	1.00	0.25	65
18	23.38	0.62	16	14.44	1.00	0.25	79
20	25.62	0.62	20	16.09	1.00	0.25	94
24	30.38	0.62	20	19.31	1.00	0.25	131